

- EXISTING LEGEND:**
- EXISTING INDEX CONTOUR
 - EXISTING INTERMEDIATE CONTOUR
 - EXISTING CHAIN LINK FENCE
 - EXISTING COMBINED SEWER LINE
 - EXISTING GAS LINE
 - EXISTING WATER LINE
 - EXISTING OVERHEAD ELECTRIC
 - EXISTING BUSHES
 - EXISTING SPOT ELEVATION
 - EXISTING SPOT ELEVATION (TOP OF CURB)
 - EXISTING SPOT ELEVATION (BOT. OF CURB)
 - SIGN
 - COMBINATION MANHOLE
 - WATER BOX (WATER VALVE)
 - FIRE HYDRANT
 - WATER METER BOX
 - GAS BOX (GAS VALVE)
 - TREE, DECIDUOUS (SIZE)
 - GUY WIRE

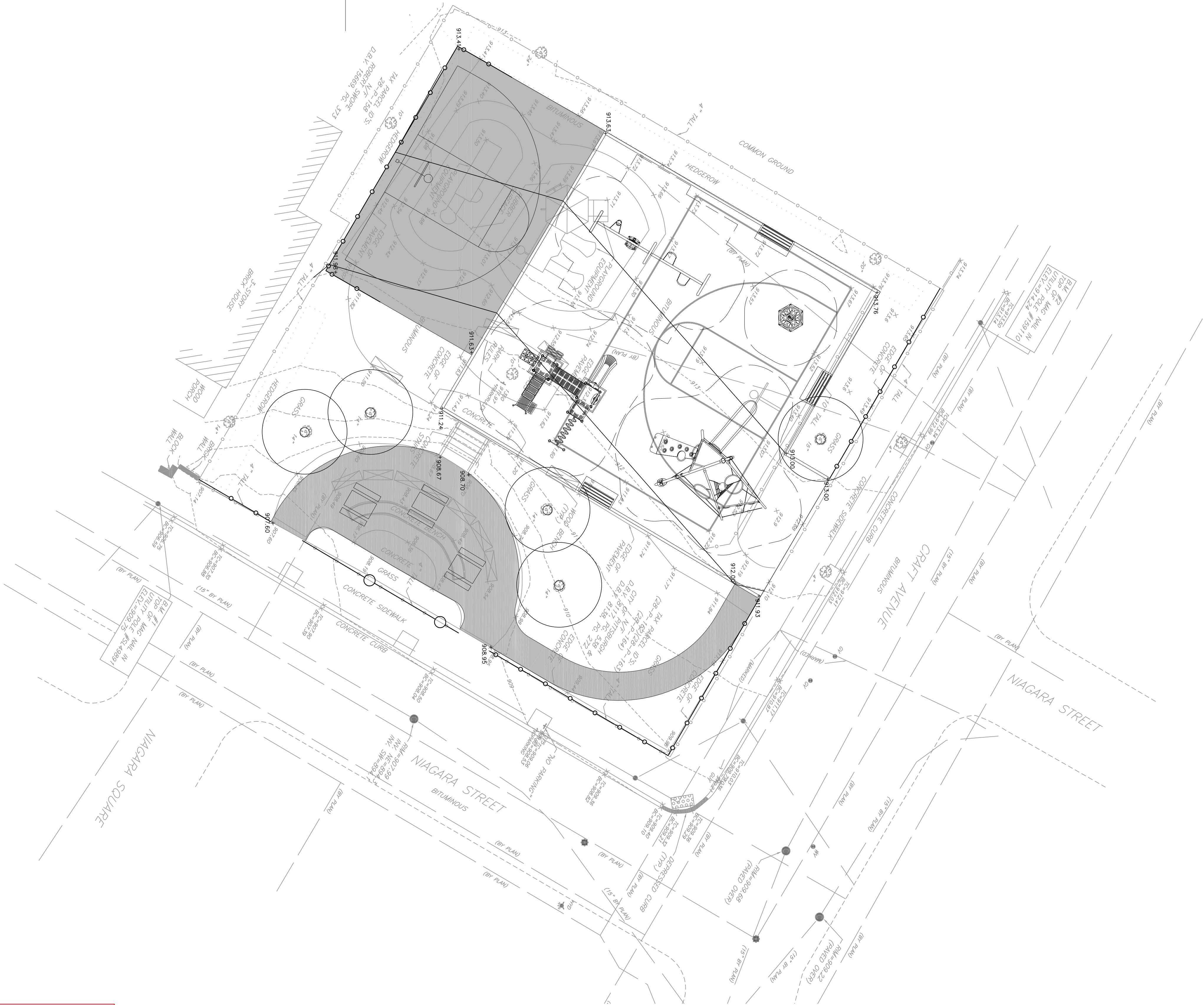

SURVEY NOTES:

SURVEY INFORMATION OBTAINED FROM A TOPOGRAPHICAL SURVEY PREPARED BY CIVIL AND ENVIRONMENTAL CONSULTANTS ON JULY 30, 2019.

LAYOUT NOTES:

1. VERIFY LAYOUT WITH OWNER PRIOR TO CONSTRUCTION AND ADJUST AS REQUIRED
2. REPAIR AND/OR REPLACE ADJACENT PAVING DAMAGED OR REMOVED DUE TO CONSTRUCTION OPERATIONS
3. MATCH EXISTING PAVING FOR CUT AND PATCH WORK WITHIN PUBLIC RIGHTS-OF-WAY REQUIRED FOR SITE IMPROVEMENTS. IN STRICT ACCORDANCE WITH STANDARDS AND SPECIFICATIONS OF GOVERNING AUTHORITIES
4. DETERMINE THAT LOCATION OF UNDERGROUND UTILITIES OR FEATURES TO REMAIN DO NOT INTERFERE WITH PROPOSED IMPROVEMENTS. CONTACT OWNER FOR ALTERNATE LOCATIONS IF REQUIRED
5. CONSTRUCTION NOTES AND TYPICALS MAY APPEAR ONLY ONCE ON DRAWINGS, BUT APPLY TO ALL SIMILAR CONDITIONS WHERE NEW CONSTRUCTION OCCURS TO FULFILL THE INTENT OF THE DRAWINGS

GRADING NOTES:

1. VERIFY FIELD STAKE-OUT AND GRADES WITH OWNER PRIOR TO CONSTRUCTION
2. PROVIDE POSITIVE DRAINAGE IN EXISTING AND PROPOSED PAVED AND PLANTED AREAS DURING EACH PHASE OF CONSTRUCTION AND FOR FINISHED GRADES. REMOVE AND RECONSTRUCT PAVEMENT DICTATED BY FIELD CONDITIONS TO PROVIDE POSITIVE DRAINAGE AT TIE-IN POINTS
3. ELIMINATE RUTS, DEPRESSIONS AND REPAIR ERODED AREAS UPON FINAL GRADING
4. CONSTRUCT SLOPES TO A MAX 3:1 SLOPE
5. SLOPE GRADE AWAY FROM WALLS, WALKS AND EDGES OF PLAYGROUND AREAS A MINIMUM 2%, UNLESS OTHERWISE NOTED FOR ADA ACCESSIBILITY. CONSTRUCT RAMPS TO A MAXIMUM 4.9% (ALL DIRECTIONS). CONSTRUCT PLAYGROUND PAVING AND PROTECTIVE PLAY SURFACING TO MAX 2% SLOPE IN ANY DIRECTION
7. SPOTS AND CONTOURS ARE SHOWN AT PAVEMENT ELEVATIONS
8. ADJUST TOP ELEVATIONS OF EXISTING UTILITIES TO MEET PROPOSED GRADES FLUSH.

NOT FOR
CONSTRUCTION

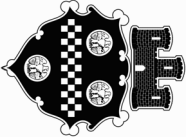

City of
Pittsburgh
Department of
Public Works
Bureau of Facilities

Revisions

NIAGARA PARK AND
PLAYGROUND RENOVATIONS

Project Address
Niagara Street
Pittsburgh ,PA 15213

Project No. 2019-87141

Scale
1" = 10'
Date
01/08/2020

Sheet Title
SITE/ GRADING
PLAN

Sheet No. SP.01
1 of 1